

Mobilität wird einfach!

Im Hofstätt 11
D-72359 Dotternhausen
Phone +49 (0)7427 9480-0
Fax +49 (0)7427 9480-7025
e-mail info@proactiv-gmbh.de
www.proactiv-gmbh.com



PROACTIV Seat and back systems

Quotation date: _____

Order date: _____

according to GTC PROACTIV GmbH

Medical suppliers/company address:

Cust. no.: _____
Name: _____
Street: _____
Postcode, city: _____
Phone: _____
Fax: _____
E-Mail: _____
Contact: _____

Shipping address: same as company address

other (see below)

Name: _____
Street: _____
Postcode, city: _____

Invoice address: same as company address

other (see below)

Cust. no.: _____
Name: _____
Street: _____
Postcode, city: _____
Phone: _____
Fax: _____
E-Mail: _____
Contact: _____

Customer name / commission:

Name: _____
Street: _____
Postcode, city: _____
Phone: _____
Fax: _____
E-Mail: _____
DoB: _____
Paying organisation: _____
Indication: _____

Order of the seat and/or back system for the following product:

New wheelchair orders

(see separate enclosed dimensional sheet:

Commission: _____)

Retrofit for a PRO ACTIVE wheelchair¹

- Type: _____
- Product number: _____
- Year of construction: _____
- Seat width SB: _____
- Seat depth ST: _____
- Back height RH: _____

Retrofit for a third-party product¹

- Seat width SB: _____
- Seat depth ST: _____
- Back height RH: _____

Please note that it is essential to observe the drawings, PROACTIV will not perform any compatibility testing!

¹The prices specified, are surcharges when ordering the wheelchairs as long as the article is not ordered for retrofitting. The prices from individual articles for retrofitting may deviate, request a cost estimate!

Seat systems

"Seat cushion or seat plate without radius contour"

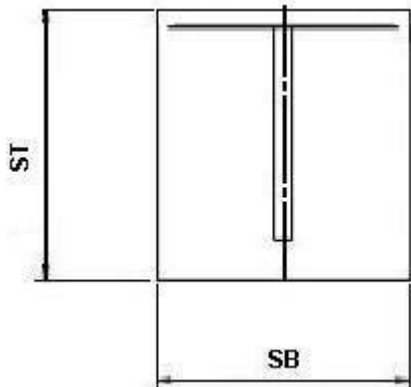

"Cushion or seat plate with radius contour"

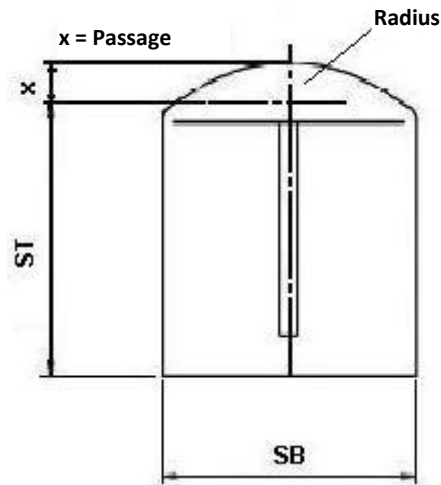

Seat plate

Aluminium seat plate with radius contour mounted on welded seat plate holders (with the new order of a wheelchair)

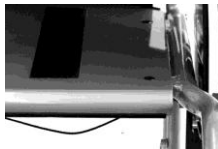

- for Speedy A1, A2, F1, F2, F4, 4all, 4you, 4teen, Buddy and Lift 9000801210 **€ 224.20**

Colour: anthracite matt (where not specified under colour selection)

Seat cushion with radius contour

Seat cushion "PRO ACTIV Standard" with radius contour



- Height: 3 cm Inlet: Standard 9000800300-003 **€ 122.60**
- Height: 4 cm Inlet: Standard 9000800300-004 **€ 122.60**
- Height: 5 cm Inlet: Standard 9000800300-005 **€ 122.60**

Cover:

- black, breathable, open fabric surface
- black, closed fabric surface

Seat cushion with a rectangular contour

Seat cushion "PRO ACTIV Anti-decubitus" with a rectangular contour



- Height: 4 cm up to 30x30 cm 9000805204-004 **€ 228.80**
- Height: 4 cm >30x30 up to 50x50 cm 9000805200-004 **€ 332.80**
- Height: 6 cm up to 30x30 cm 9000805204-006 **€ 228.80**
- Height: 6 cm >30x30 up to 50x50 cm 9000805200-006 **€ 332.80**

Cover:

- black, breathable, open fabric surface
- black, closed fabric surface

Seat cushion "PRO ACTIV Anti-decubitus" with radius contour



- Height: 4 cm up to 30x30 cm 9000800311-004 **€ 270.40**
- Height: 4 cm >30x30 up to 50x50 cm 9000800310-004 **€ 367.40**
- Height: 6 cm up to 30x30 cm 9000800311-006 **€ 270.40**
- Height: 6 cm >30x30 up to 50x50 cm 9000800310-006 **€ 367.40**

Cover:

- black, breathable, open fabric surface
- black, closed fabric surface

Back equipment with back shell

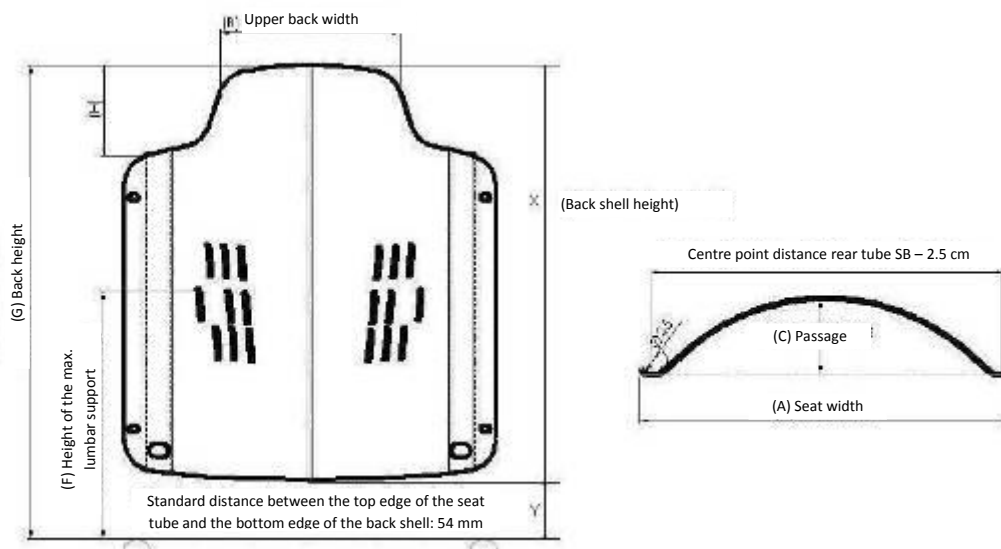

Dimensions	Dimension data	Information			
A Seat width	_____ cm				
B Upper back width		SB 18 – 22: 13 cm	SB 23 – 30: 14 cm	SB 31 – 38: 17 cm	SB 39 – 50: 19.5 cm
C Passage		SB 18 – 22: 5 cm	SB 23 – 30: 6 cm	SB 31 – 38: 6.8 cm	SB 39 – 50: 7.5 cm
F Max. lumbar support height	_____ cm	under SB 24 cm without lumbar belts	SB 27 – 36 cm 18.5 – 20.5 cm	SB 37 – 43 cm 20.5 – 22.5 cm	SB 44 – 50: 22.5 – 24 cm
G Back height	_____ cm	min. 24 cm			
H		< RH 25 cm: 4.5 cm	RH 25 – 48: 5.5 cm	RH 49 – 52: 7.0 cm	

Ergonomics – aluminium back shell from RH 24 cm

for Buddy
9041802210

€ 338.00

Colour: anthracite matt
(where no colour specified under colour selection) compatible with push handles
Art. no. 9041401075-001; 9041401075-002; 9041401080 and 9041401085!



Back cushions, if desired, please select separately!

Ergonomics – aluminium back shell from RH 24 cm

for Speedy A1, A2, F1, F2, F4, 4all, 4you, 4teen and Lift
9000802210

€ 338.00

with lumbar support
Colour: anthracite matt
(where not specified under colour selection)



Back cushions, if desired, please select separately!

ERGO Back backrest bracket for Ergonomics back shell from RH 24 and SB 30

for Buddy
9041802019

€ 222.90

with recessed gripping area
Colour: anthracite matt
(where not specified under colour selection)
Select back shell separately!
Only compatible with push handles Art. no. 9041401082!



Back cushions, if desired, please select separately!

ERGO Back backrest bracket for Ergonomics back shell from RH 24 and SB 30

for Speedy A1, A2, F1, F2, F4, 4all, 4you, 4teen, and Lift
9000802019

€ 222.90

with recessed gripping area
Colour: anthracite matt
(where not specified under colour selection)
Select back shell separately, not in conjunction with push handles!



Back cushions, if desired, please select separately!

Back cushion for ergonomic back shell

9000802220

€ 167.10

Cushion thickness 2 cm
Cover:

- black, breathable, open fabric surface
 black, closed fabric surface



Ergonomics – aluminium back shell from RH 34 and SB 33 cm

for Traveler
9030802210

€ 474.10

with lumbar support,
Fastening to the back cross arm, via snap-on link, removable
Colour: anthracite
(where not specified under colour selection)



Back cushions, if desired, please select separately!

**Back equipment
with ERGO Back backrest bar**

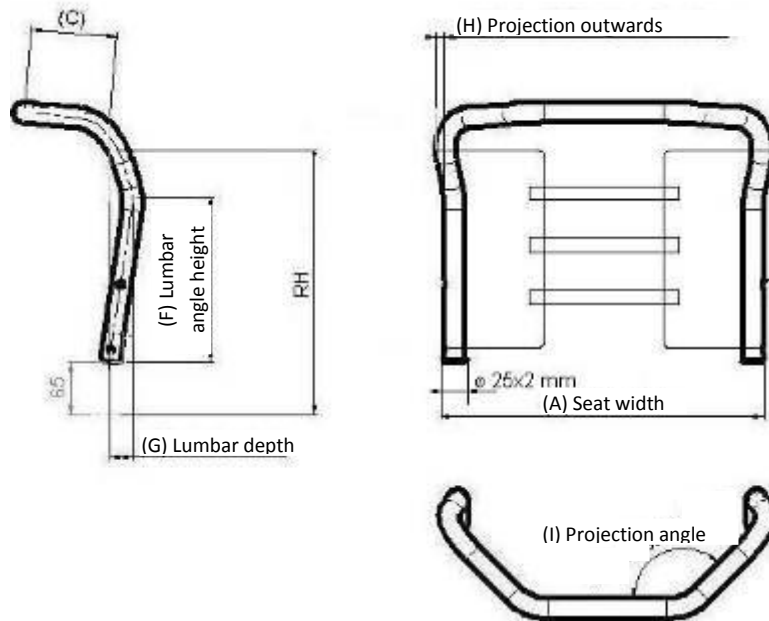

Dimensions	Dimension data	Information
A Seat width	_____ cm	
B Back height	_____ cm	
C	_____ cm	min. 10,5 cm, standard 12 cm
F Lumbar angle height Only select for article number 9000802016	_____ cm	The lumbar angle height depends on the physical conditions as well as on seat system. If not specified: standard height 23 cm.
G Lumbar depth	_____ cm	Recommendation: 2 – 3 cm If not specified: Standard 2 cm
H Projection outwards	_____ cm	max. 1 cm for folding backrest max. 2 cm backrest fixed
I Projection angle	_____ °	Standard: 120° (min. 95° - max. 135°)

**ERGO Back straight backrest bar
from RH 20 and SB 30 cm**

- for Speedy A1, A2, F1, F2, F4, 4all, 4you, 4teen, and Lift 9000802018 **€ 222,90**

With recessed gripping area, adjustable backrest tensioner and cushion
Colour: anthracite matt
(where not specified under colour selection)
Not in combination with push handles!

**ERGO Back straight backrest bar
from RH 20 and SB 30 cm**

- Buddy 9041802018 **€ 222,90**

With recessed gripping area, adjustable backrest tensioner and cushion
Colour: anthracite matt
(where not specified under colour selection)
Only compatible with push handles Art. no.: 9041401082!

**ERGO Back straight backrest bar
with lumbar curvature
from RH 31 and SB 30 cm**

- for Speedy A1, A2, F1, F2, F4, 4all, 4you, 4teen, and Lift 9000802016 **€ 243,40**

With recessed gripping area, adjustable backrest tensioner and cushion
Colour: anthracite matt
(where not specified under colour selection)
Not in combination with push handles!

**ERGO Back backrest bar
with lumbar curvature
from RH 31 and SB 30 cm**

- Buddy 9041802016 **€ 243,40**

With recessed gripping area, adjustable backrest tensioner and cushion
Colour: anthracite matt
(where not specified under colour selection)
Only compatible with push handles Art. no.: 9041401082!



Colour

Information about current colour designs and availability at:
www.proactiv-gmbh.com

Standard colour:

Anthracite RAL 7016

gloss 9000100179-995

- Back shell
- ERGO Back backrest bar
- Aluminium seat plate

In frame colour:

9000100179-999 € 70.70

- Back shell
- ERGO Back backrest bar
- Aluminium seat plate

For frame coating in two-colour design:

please let us know coating of the selected options
in base colour or design colour.

- Back shell
- Base colour
- Design colour

- ERGO Back backrest bar
- Base colour
- Design colour

- Aluminium seat plate
- Base colour
- Design colour

If another colour is desired, please select this from the wheelchair colour scheme:

In colour from one-colour design:

9000100179-998 € 114.40

Please enter the last 3 digits of the desired colour
(single colour design):

9000100170-

- Back shell
- ERGO Back backrest bar
- Aluminium seat plate

In colour from two-colour design:

9000100179-997 € 185.10

Please enter the last three digits of the desired
colour (two-colour design):

9000100170-

- Back shell
- ERGO Back backrest bar
- Aluminium seat plate

Your additional notes:

I herewith confirm the details listed above

Location, Date

Signature (End customer)

Location, Date

Signature (Dealer)