

Im Hofstätt 11  
D- 72359 Dotternhausen  
Phone +49 (0)7427 9480-0  
Fax +49 (0)7427 9480-7025  
E-Mail info@proactiv-gmbh.de  
www.proactiv-gmbh.com



Quotation date: \_\_\_\_\_

Order date: \_\_\_\_\_

according to GTC PRO ACTIV GmbH

**Medical suppliers/company address:**

Cust. no.: \_\_\_\_\_  
Name: \_\_\_\_\_  
Street: \_\_\_\_\_  
Postcode, city: \_\_\_\_\_  
Phone: \_\_\_\_\_  
Fax: \_\_\_\_\_  
E-Mail: \_\_\_\_\_  
Contact: \_\_\_\_\_

Invoicing address, other (see below)

Cust. no.: \_\_\_\_\_  
Name: \_\_\_\_\_  
Street: \_\_\_\_\_  
Postcode, city: \_\_\_\_\_

Shipping address, other (see below)

Cust. no.: \_\_\_\_\_  
Name: \_\_\_\_\_  
Street: \_\_\_\_\_  
Postcode, city: \_\_\_\_\_

**Customer name/commission:**

Name: \_\_\_\_\_  
Street: \_\_\_\_\_  
Postcode, city: \_\_\_\_\_  
Phone: \_\_\_\_\_  
Fax: \_\_\_\_\_  
E-Mail: \_\_\_\_\_  
DoB: \_\_\_\_\_  
Paying organisation: \_\_\_\_\_  
Indication: \_\_\_\_\_

**NJ1 Compact bike**

**with hub gear and back pedal brake**

*Maximum user weight limit 100 kg*

- girder chassis with reinforcing brace
- drive unit, can be decoupled via the eccentric quick-lock system
- A-shaped handles with integrated switching and brake fittings
- infinitely adjustable backrest
- 6° wheel camber
- back pedal brake integrated in the hub gear
- Shimano V-brake (rim brake) incl. locking mechanism
- safety flag

9100101000      € 3,390.00

**Services:**

**Delivery, instruction and handing over at the customer by PRO ACTIV**

9990000003      € 425.00

plus shipping costs

**Body size**

Body height: \_\_\_\_\_ cm

Weight: \_\_\_\_\_ kg

## Chassis colour

Information on current colour designs and example images under:  
www.proactiv-gmbh.de/farben.php

### White RAL 9016

- gloss 9000100170-023
- matt 9000100170-123     **€ 33.30**

### Brilliant silver

- gloss 9000100170-011

### Anthracite RAL 7016

- gloss 9000100170-001
- matt 9000100170-101     **€ 33.30**

### Black RAL 9005

- gloss 9000100170-003
- matt 9000100170-019     **€ 33.30**

### Deep black, silver effect

- gloss 9000100170-007

### Pure orange RAL 2004

- gloss 9000100170-022

### Fire Red

- gloss 9000100170-018
- matt 9000100170-118     **€ 33.30**

### Pink magenta RAL 4010

- gloss 9000100170-037
- matt 9000100170-137     **€ 33.30**

### Sky blue

- gloss 9000100170-017

### Pastel blue RAL 5024

- gloss 9000100170-036
- matt 9000100170-136     **€ 33.30**

### Marine blue

- gloss 9000100170-045
- matt 9000100170-145     **€ 33.30**

### Apple green

- gloss 9000100170-014
- matt 9000100170-114     **€ 33.30**

### Lemon green

- gloss 9000100170-005
- matt 9000100170-105     **€ 33.30**

### Violet

- gloss 9000100170-044

### Yellow RAL 1023

- gloss 9000100170-046
- matt 9000100170-146     **€ 33.30**

### Red RAL 3001

- gloss 9000100170-047
- matt 9000100170-147     **€ 33.30**

### Powder coating, transparent

- gloss 9000100170-029

## Black Shadow, deep black drive unit RAL 9005, smooth gloss

- 9110100170-001     **€ 103.80**

- fork tube R and L
- fork bridge, top and bottom
- bottom bracket support

## Hub drive system

### Shimano "Nexus" 7-speed hub gear

- 9100200022
- "Grip Shift" twist grip shifter
- Gear ratio: Sprocket 32 teeth,  
Cassette 20 teeth
- (with bottom bracket support L – 19 teeth)



### Shimano "Nexus" 8-speed hub gear

- 9100200023     **€ 138.50**
- "Grip Shift" twist grip shifter
- Gear ratio: Sprocket 32 teeth,  
Cassette 20 teeth
- (with bottom bracket support L – 19 teeth)



## Gear change accessories

### Mountain drive 2.5: 1 gear reduction for hills in combination with hub gear

- 9100200003     **€ 499.80**
- Planetary gear set for doubling of the number of  
gears
- All gears (the hub gear and the gear reduction  
for hills) can be changed when stationary.
- In combination with grip width 40 or 45 cm!



## Chassis

### Chassis geometry

- Length 104 cm  
Seat width  
approx. 39 cm  
9100100000-001
- Length 116 cm  
Seat width  
approx. 39 cm  
9100100000-002
- Length 116 cm     **€ 161.20**  
Seat width  
approx. 43 cm  
9100100000-003
- Heavy Duty version     **€ 335.50**  
up to 120 kg body weight  
9100800013

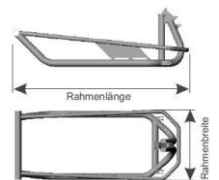

## Drive unit colour

### Silver, anodised drive unit

- 9110100170-000

## Dimensions

### Pedal bearing shaft

- Grip width 40 cm  
9100500100-040
- Grip width 45 cm  
9100500100-045
- Grip width 50 cm  
9100500100-050

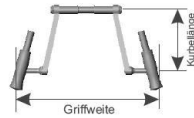

### Fixed bottom bracket support

- XS (X/Y 113/130)  
9100501100-004
- S (X/Y 67/153)  
9100501100-003
- M (X/Y 90/250)  
9100501100-001

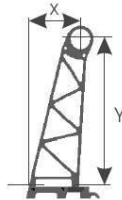

### Adjustable bottom bracket support

- 9100500001 **€ 182.90**

Adjustable angle via clamped hinge on the fork bridge and in their length.

For the pre-setting, please specify the bottom bracket support size that comes as close to your desired position.



Size: \_\_\_\_\_

If not specified, the adjustable bottom bracket support size S will be delivered.



### Pedal crank

- Length 155 mm  
9100600100-155
- Length 175 mm  
9100600100-175
- Length 195 mm  
9100600100-195



### Customer-specific crank length according to dimension

\_\_\_\_\_ mm (minimum length 125 mm)

- 9100600101 **€ 155.80**

## Leg rest

### Leg rest separated

- 9100100008  
Adaptation on the fork for short legs  
Only possible up to body size 165 cm!



### Leg rest wrapping

- 9100100009  
Adaptation on the fork



### Leg rest adapted to the chassis

- 9100100010 **€ 400.40**

Legs not influenced by steering movement.  
Increases the vehicle width!  
Not in combination with the leg shield.



### Foot stopper for leg rest

- 9100100012 **€ 71.90**



### Thigh anchorage

- 9100100013 **€ 127.90**



## Back equipment

### Backrest with filler and 1.5 cm foam padding

- 9100800000



### Body contour back padding

- 9100800010 **€ 123.80**

with back padding 3 cm  
Cover: black/breathable



## Seat upholstery

### Open belt system seat upholstery

- 9100801010



### Body contour seat upholstery

- 9100801025  
breathable, cushioning effect



## Seat cushion

shape dimensions in cm	seat cushion "Standard" 9100000190	seat cushion with upper leg guidance 9100800103
	Chassis: 104 SB: 39 ST: 30	-001 <input type="checkbox"/>
Chassis: 116 SB: 39 ST: 40	-002 <input type="checkbox"/>	-002 <input type="checkbox"/>
Chassis: 116 SB: 43 ST: 40	-003 <input type="checkbox"/>	-003 <input type="checkbox"/>
price	<b>€ 88,30</b>	<b>€ 161,10</b>

Cover: black, breathable, open fabric surface  
height: 4cm

seat cushion with upper leg guidance only in combination with hip safety belt.

## Wheels

### Running wheels with double-wall rim

- 26" (559)  
9100104260

## Tyres

### Schwalbe "Durano"

- 26x1.1" (559-28)  
9100105000

Racing-Slic

### Schwalbe Marathon Plus Tour

- 26x2,0" (559-50) € 58.80  
9100105140



### Bracket ø 22 mm x 42 mm for fixing of accessories (speedometer, lighting, or similar)

- 9110903271 Item price € 18.30

Colour: natural anodised

\_\_\_\_\_ Items



### Lighting set SIGMA Lightster LED with bracket

- 9100900019 € 102.50

with battery charger and set of batteries (4 pcs. NICD) front and rear lights



## Options for users with reduced function

### Tetra hand support, pivotable, adjustable grip distance

- 9110601101 € 140.30



### Tetra shell handles

- 9110601100 € 135.90



### Tetra backhand support

- 9110601102 € 158.60

pivotable, adjustable distance to the bike handle



## Bike accessories

### Plug-in protection plate

- 9110502100 € 45.80



### Leg guard

- 9100100231 € 141.50

Guard for MTB tyres  
Screwed onto the fork tube  
Colour: black matt

### Collision guard clamped on the axle tube

- 9100800100 € 171.80

with 40 mm mounting clip



### Neck rest

- 9100800150 € 206.00

height-adjustable  
angle-adjustable



### Hip safety belt

- 9100800200 € 93.50



### SIGMA BC 1200 Bike Computer

- 9110901000 € 55.30

wireless  
with bracket



### SIGMA BC 1606L DTS Bike Computer

- 9110900018 € 135.20

with pedal frequency set  
wireless



### Your additional notes:

I herewith confirm the details listed above

Location, Date

Signature (End customer)

Location, Date

Signature (Dealer)